

NEW ACADEMIC CENTER AND FRESHMAN HONORS PROGRAM
at Northeastern University

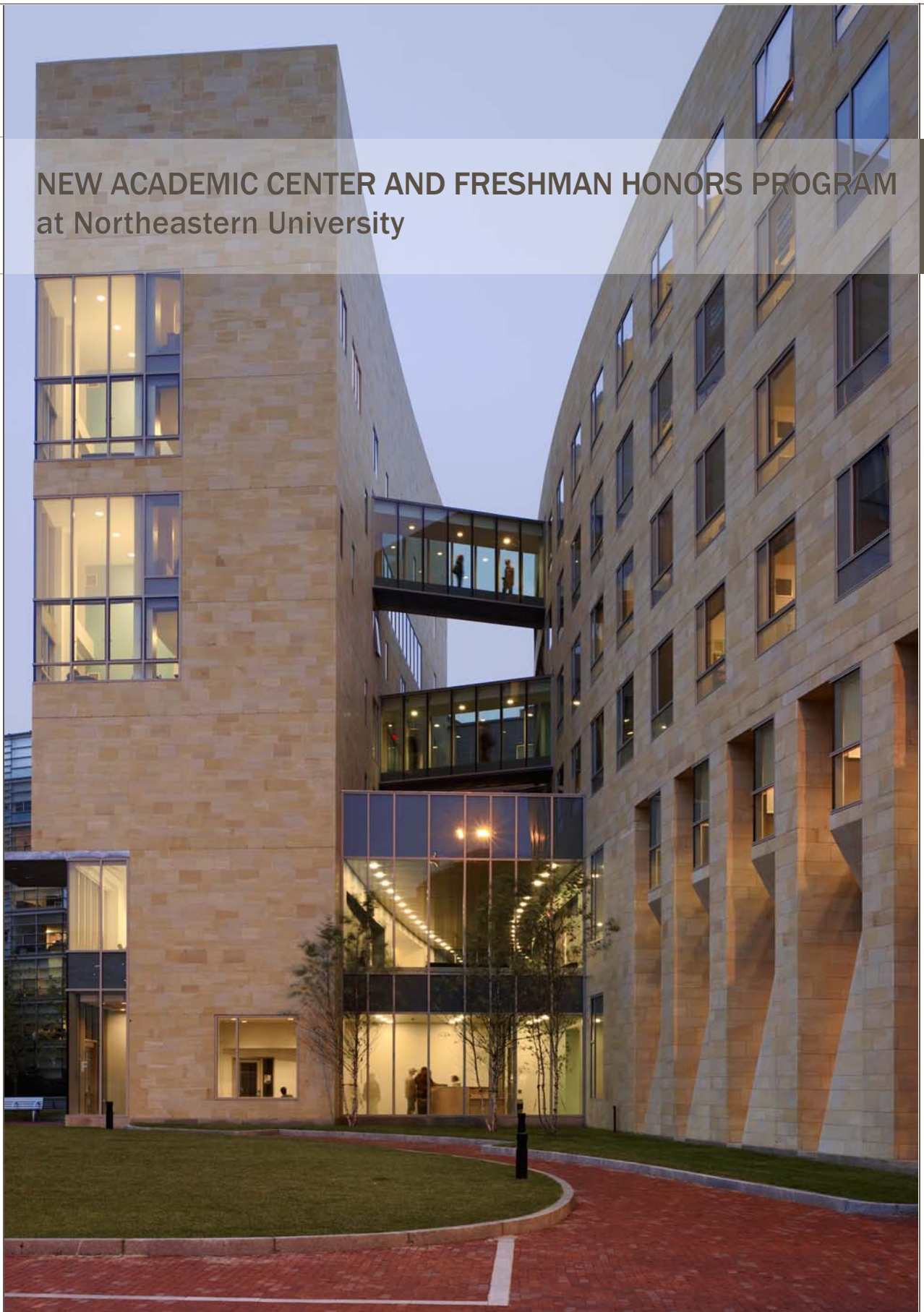

William Rawn Associates, Architects, Inc., Boston, MA

New Academic Center And Freshman Honors Program (Building F)

As the sixth new building designed by our firm for Northeastern University's new West Campus, Building F completes the buildout of the 1.2 million square foot Master Plan also by our firm. This new 140,000 s.f. mixed-use building is designed to reinforce this University's strong academic mission:

- The Academic Center adds 7 classrooms (totaling 300 seats) and a 270-seat auditorium, bringing the classroom count to 18 in these six new buildings. The Academic Center anchors the lower three floors to the central pedestrian promenade of the West Campus.
- The Honors Program Offices occupy a prominent ground floor location at the front door to the Freshman Honors Residence Hall.
- The Freshman Honors Residence Hall, with 230 beds in 6-person apartments on the upper 5 floors, celebrates academic excellence at the heart of this new mixed-use sector of campus.
- The John D. O'Bryant African American Institute, located on the lower two floors, celebrates academic diversity and outreach.



3-story Atrium opens academic center to active pedestrian promenade.



- | | | | |
|---|------------------------|---|------------------------|
|  | Residence Hall (Entry) |  | Cultural Center |
|  | Academic Center |  | Honors Program Offices |



The 270-seat Media Center was designed to be used for large classes, admissions presentations, movies, and press events.

State-of-the-art technology allows these classrooms to provide a robust infrastructure that facilitates multiple setups maximizing flexibility in teaching styles in a large classroom setting.

The 270-seat auditorium features:

- Three ceiling mounted data/video projectors for dual or wide screen presentation.
- Surround sound (including subwoofers) and ceiling speaker system.
- Video cameras for a variety of uses including taping, video streaming, distance learning, or teleconferencing.
- “Smart” teaching podium with touch screen pre-programmed room/audiovisual/lighting control program.
- Natural daylighting with motorized room blackout shades.
- Wireless transmitters plus infrared based assisted listening system.





PROJECT TEAM

ARCHITECT

William Rawn Associates, Architects, Inc.
with Stull and Lee, Inc.
(Architect for the John D. O'Bryant African-American Institute)

STRUCTURAL ENGINEER

LeMessurier Consultants

MECHANICAL AND ELECTRICAL ENGINEER

Cosentini Associates

CIVIL ENGINEER

Brassard Design and Engineering

SURVEY

R.E. Cameron Associates

GEOTECHNICAL ENGINEER

Haley & Aldrich, Inc.

CODE

Sullivan Code Group

LIGHTING DESIGN

Ripman Lighting Consultants

LANDSCAPE DESIGN

Pressley Associates, Inc.

CONSTRUCTION MANAGER

Turner Construction Company

2008 Design Award for Housing, Boston Society of Architects

PROJECT FACTS

PROJECT NAME

Classroom Building, Cultural Center, and Residence Hall
(Building F)

CLIENT & CONTACT

Northeastern University

Nancy May, Director of Capital Projects

617.373.2623

CONSTRUCTION

20 months

DATE OF COMPLETION

August 2006

SIZE

140,000 s.f.

USES

Freshman Honors Program with Residence Hall (230 beds),
Auditorium, Classrooms, and the John D. O'Bryant
African-American Institute



West Campus Master Plan (A-H) by William Rawn Associates, Architects, Inc.

William Rawn Associates, Architects, Inc.

10 Post Office Square, Suite 1010, Boston, MA 02109
t) 617.423.3470 f) 617.451.9205 www.rawnarch.com